

ASSEMBLY INSTRUCTIONS

Kit Contents :-

1. Bolts - 13Pc.
25x8mm.

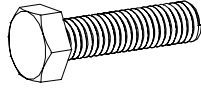

2. Washers - 13Pc.
8mm.

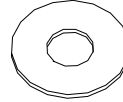

3. Spanner - 1Pc.
12-13mm.

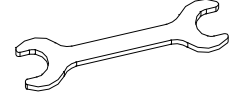

Instructions :-

1. Place the nightchest & base on a protective surface.
2. Match the holes on legs with bottom of nightchest holes as shown in image 2.
3. Now fix the legs with top nightchest using bolts & washers with spanner provided. (as shown in image 3)
4. Turned the nightchest upright & is ready to use.

